

23RD ANNUAL



23RD LCI CONGRESS
OCTOBER 19-22

2021 Congress Chair Welcome

Michael Williams, Stantec

LEARN BY DOING FROM THOSE WHO DO

October 20, 2021

Arizona

Raise your hand if you live in
Arizona...

...Keep it up if you were born in
Arizona...

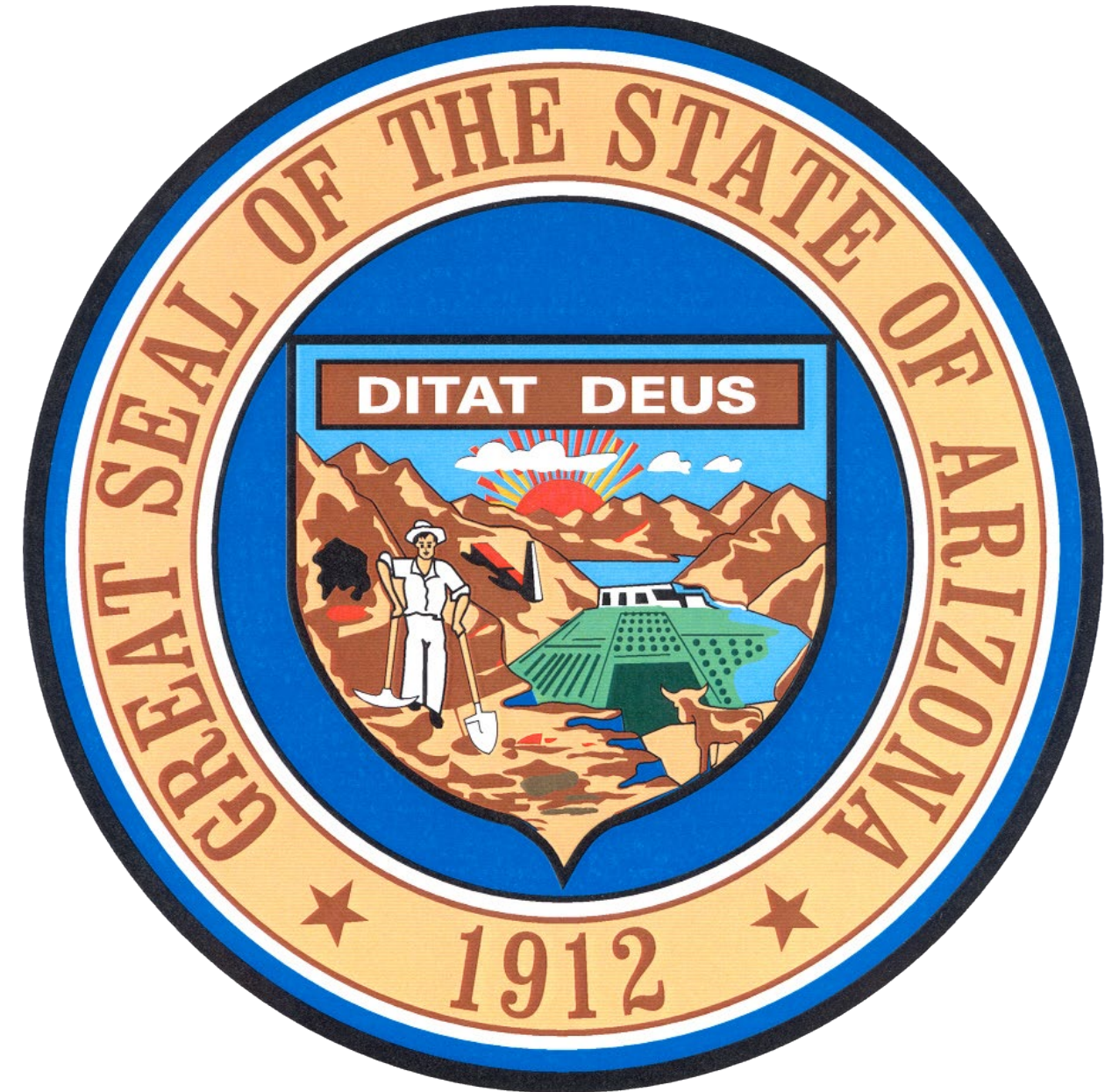

LEARN BY DOING FROM THOSE WHO DO

Arizona



LEARN BY DOING FROM THOSE WHO DO

Arizona



5 C's of Arizona

1. **Climate**

2.-

3.-

4.-

5.-

6.?



5 C's of Arizona

1. Climate

2. Copper

3.-

4.-

5.-



5 C's of Arizona

1. Climate
2. Copper
3. Citrus
- 4.-
- 5.-



5 C's of Arizona

1. Climate
2. Copper
3. Citrus
4. Cattle
- 5.-



5 C's of Arizona

1. Climate
2. Copper
3. Citrus
4. Cattle
5. **Cotton**



✖...6 C's of Arizona

.... And as of today, we can add a 6th “C” Congress!!



Venue Guide

3rd Floor/ General Sessions

WEST BUILDING | 300 LEVEL

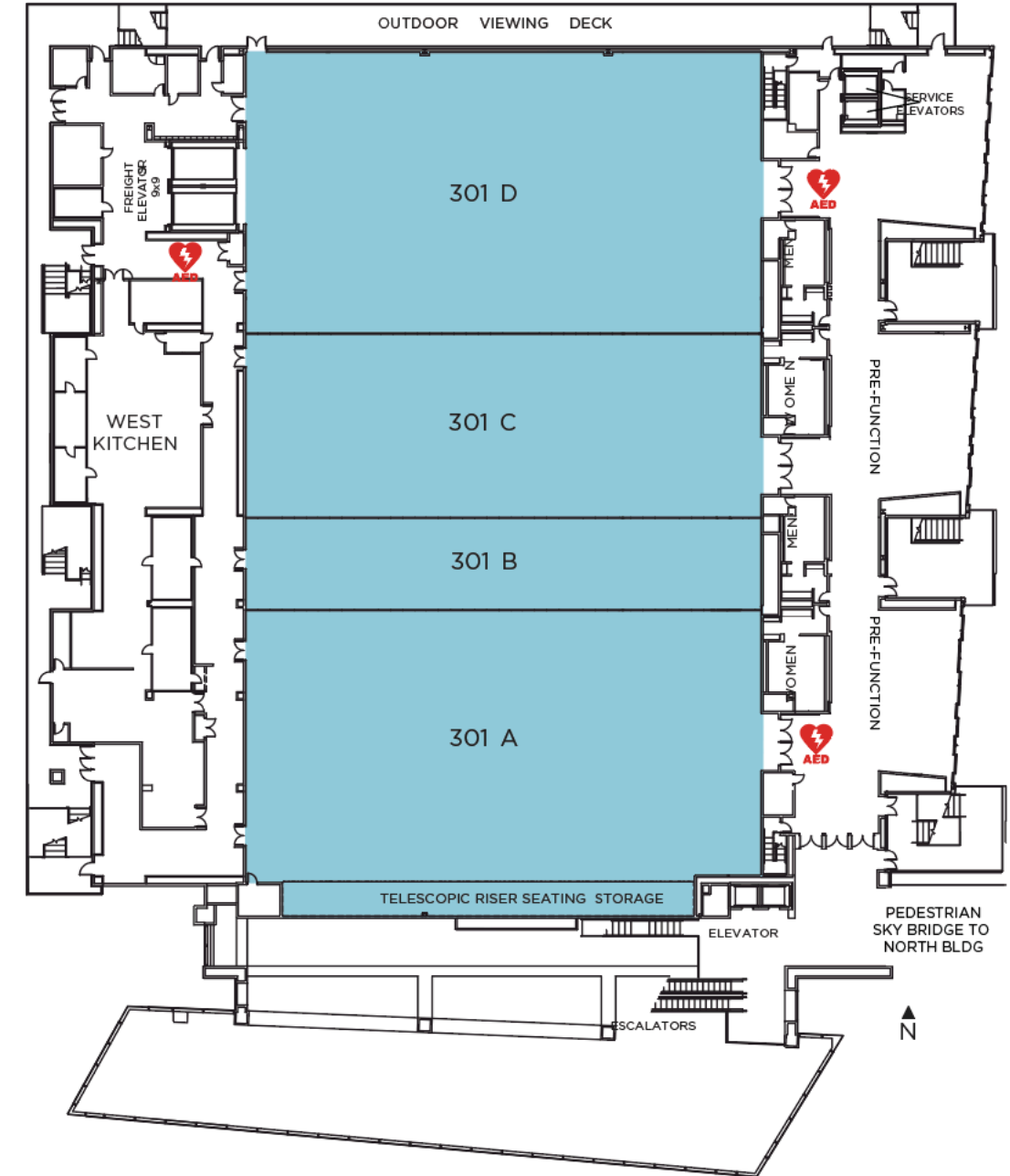

Venue Guide – Concurrent Sessions

WEST BUILDING | 100 LEVEL

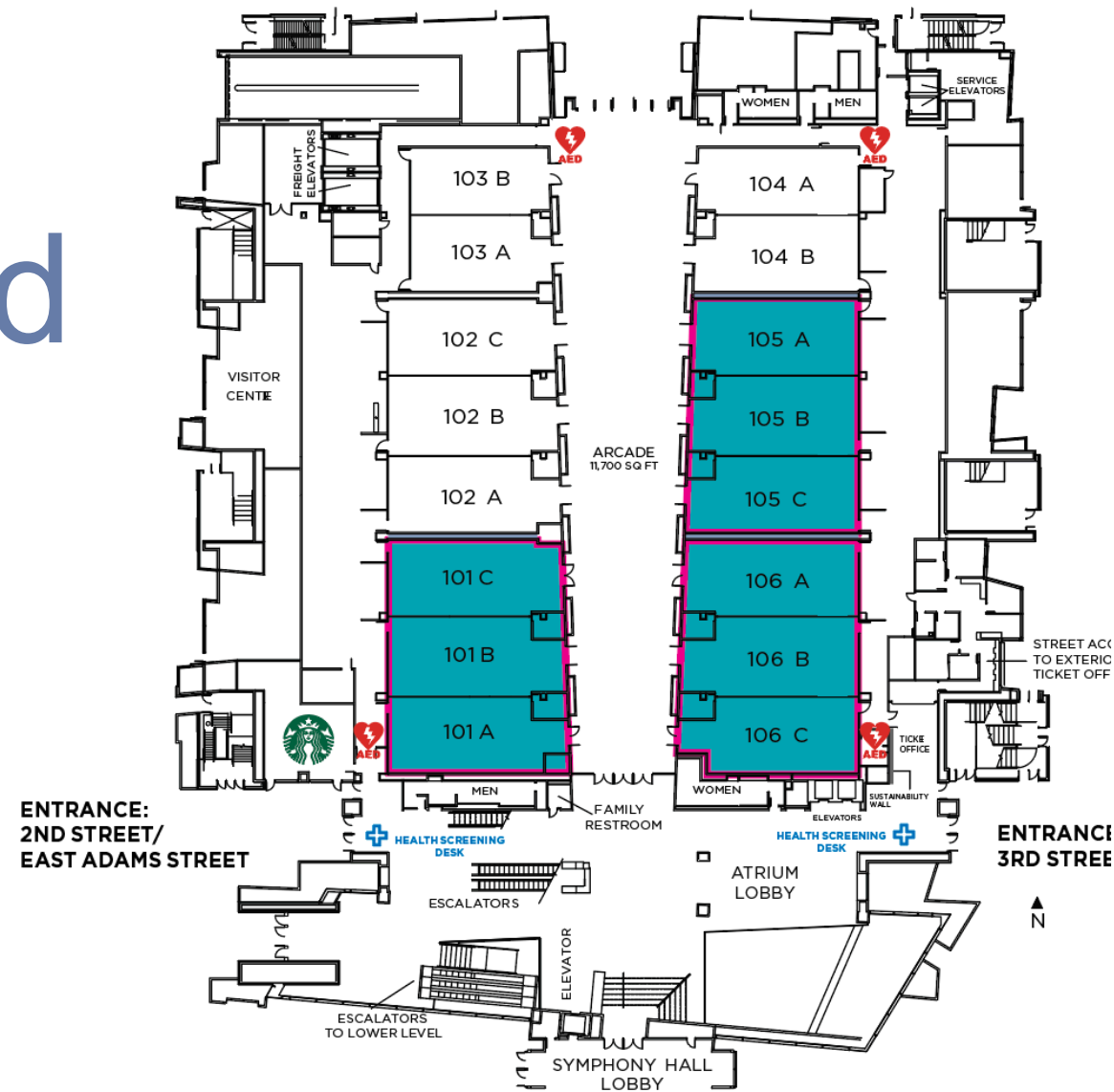

WEST BUILDING | 200 LEVEL

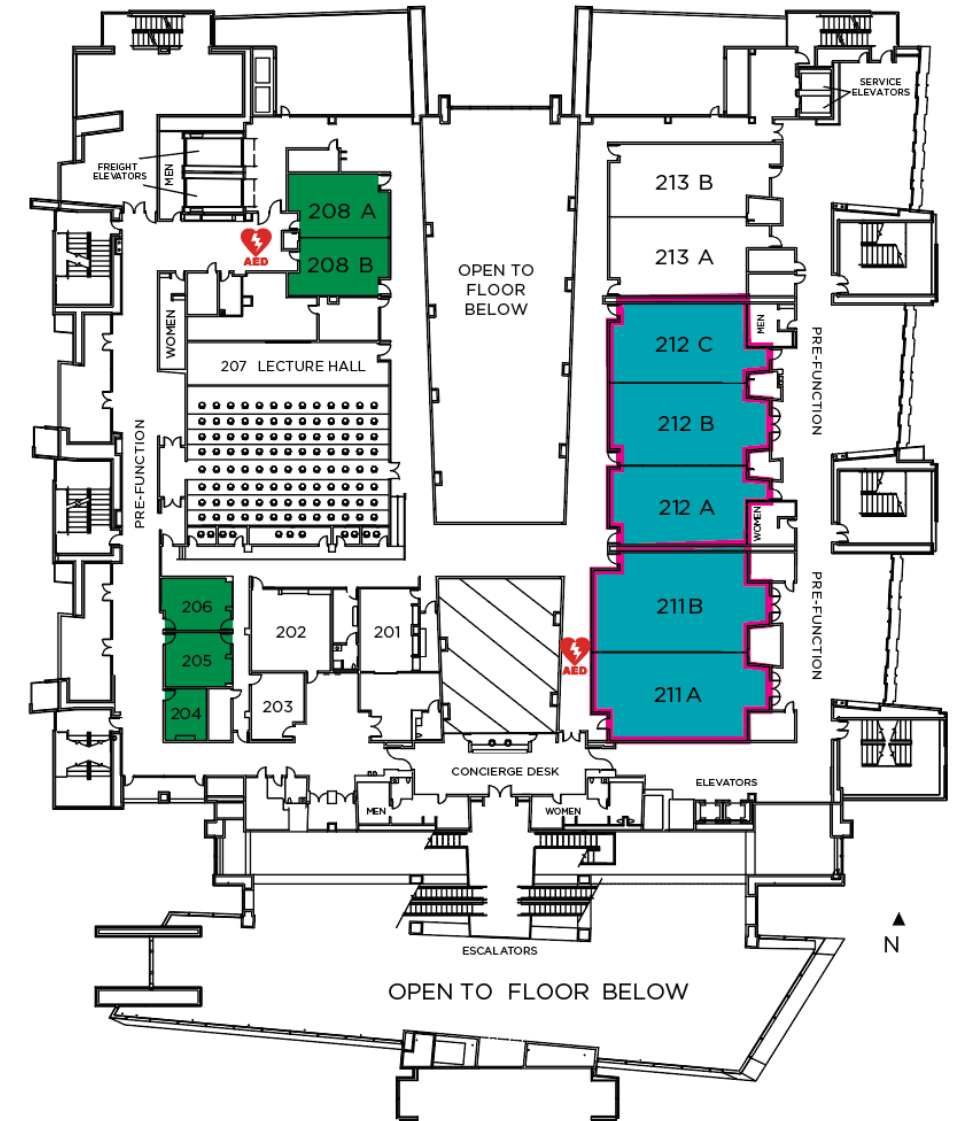

1st & 2nd
Floors

Venue Guide

Lower Level/ Exhibit Hall Registration desk

Enjoy coffee breaks in the Exhibit Hall!

KEY





- | | |
|---|--|
|  App/Membership/eLearning |  On-Site Registration |
|  Communities of Practice Table |  Volunteer table |
|  On-Demand Badge Printing | |

EXHIBIT HALL



Download LCI Congress Mobile App

Search **Lean Construction Institute** in the app store, then download

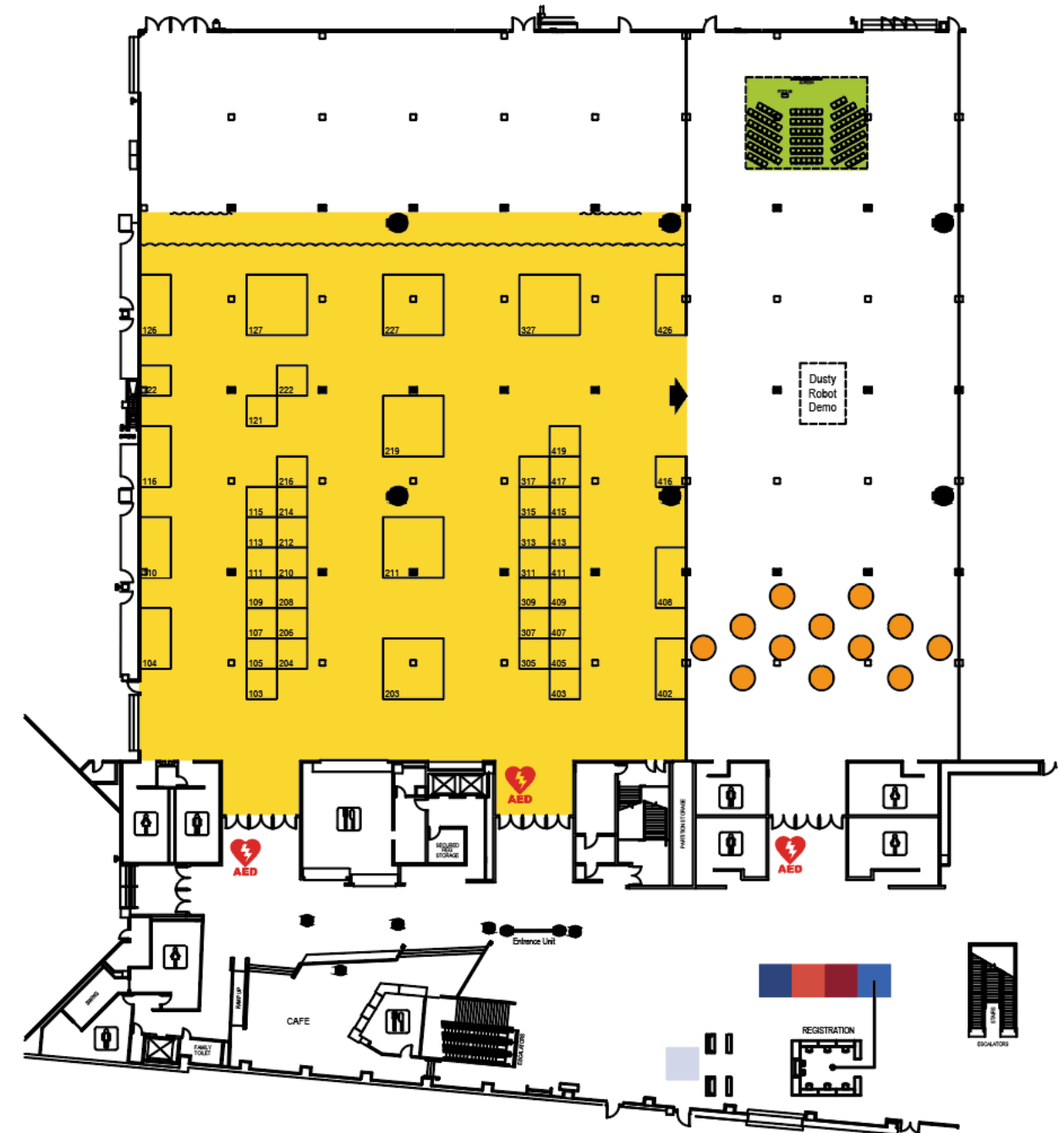
- Sign in using your first name, last name and email address that you registered with
- You will receive a 6 digit verification code via email, input this code to authenticate
- Any trouble shooting, stop by and visit our app resource in the registration area!

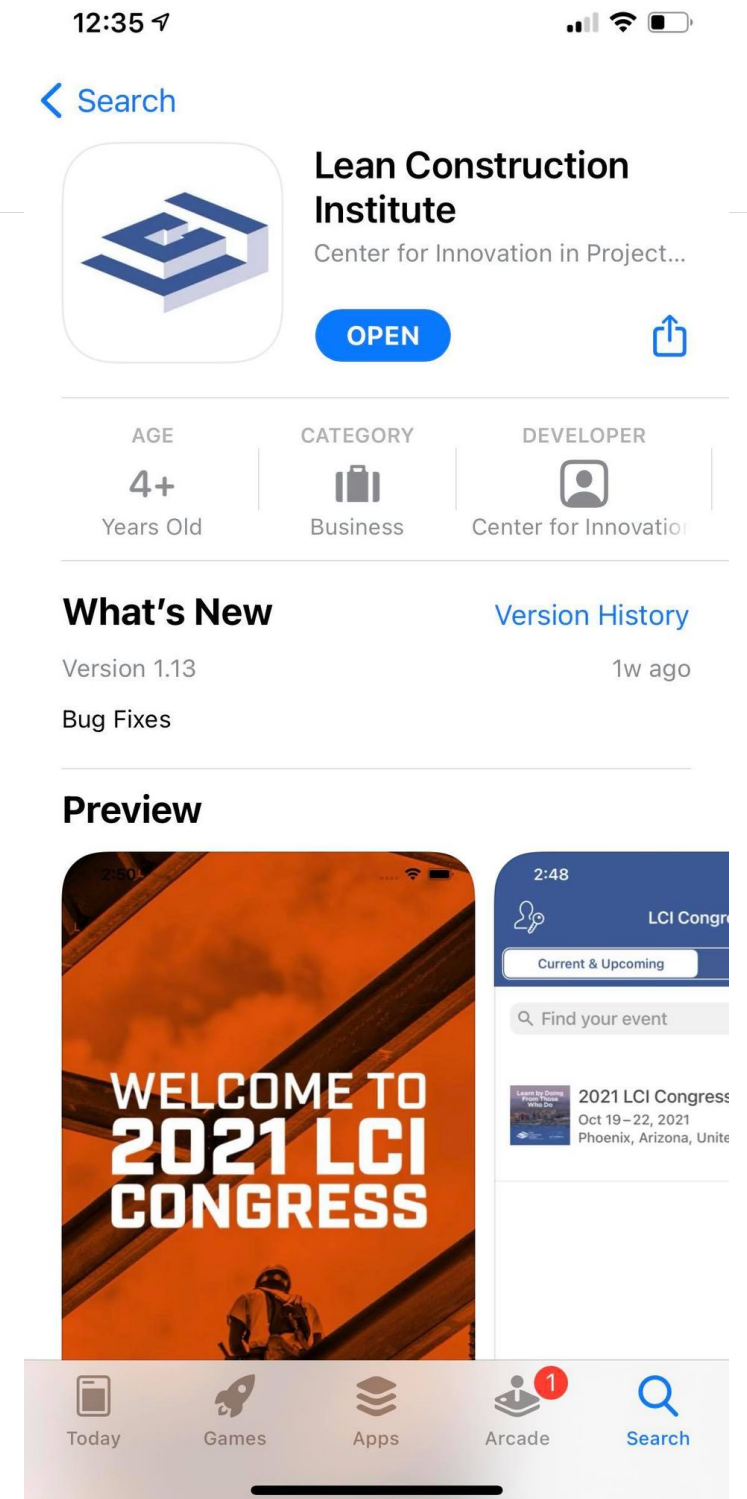

LCI Congress Mobile App

Use the 2021 Congress mobile app to

- View your schedule
- Preview session selections
- View speaker information
- Reference the venue map
- See what exhibitors are in the Exhibit Hall
- See the social feed

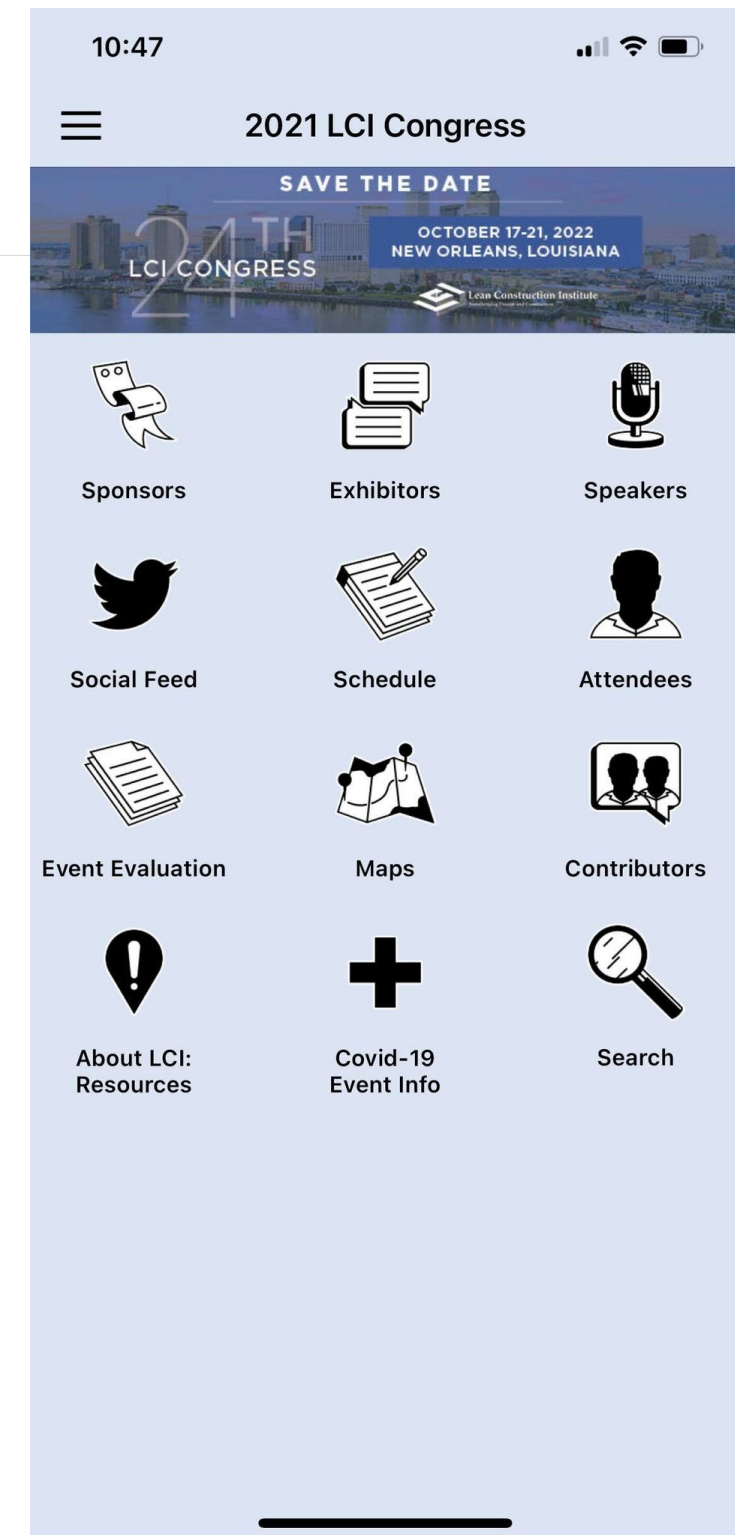

Rate Presentations in the App

Continuous improvement: give presenters your feedback by taking the session evaluation!

1. Find the session under “schedule”
2. Click on it then scroll down
3. Click “core program evaluation”
4. Complete the 5 question evaluation

This information will determine the top 5 presentation teams

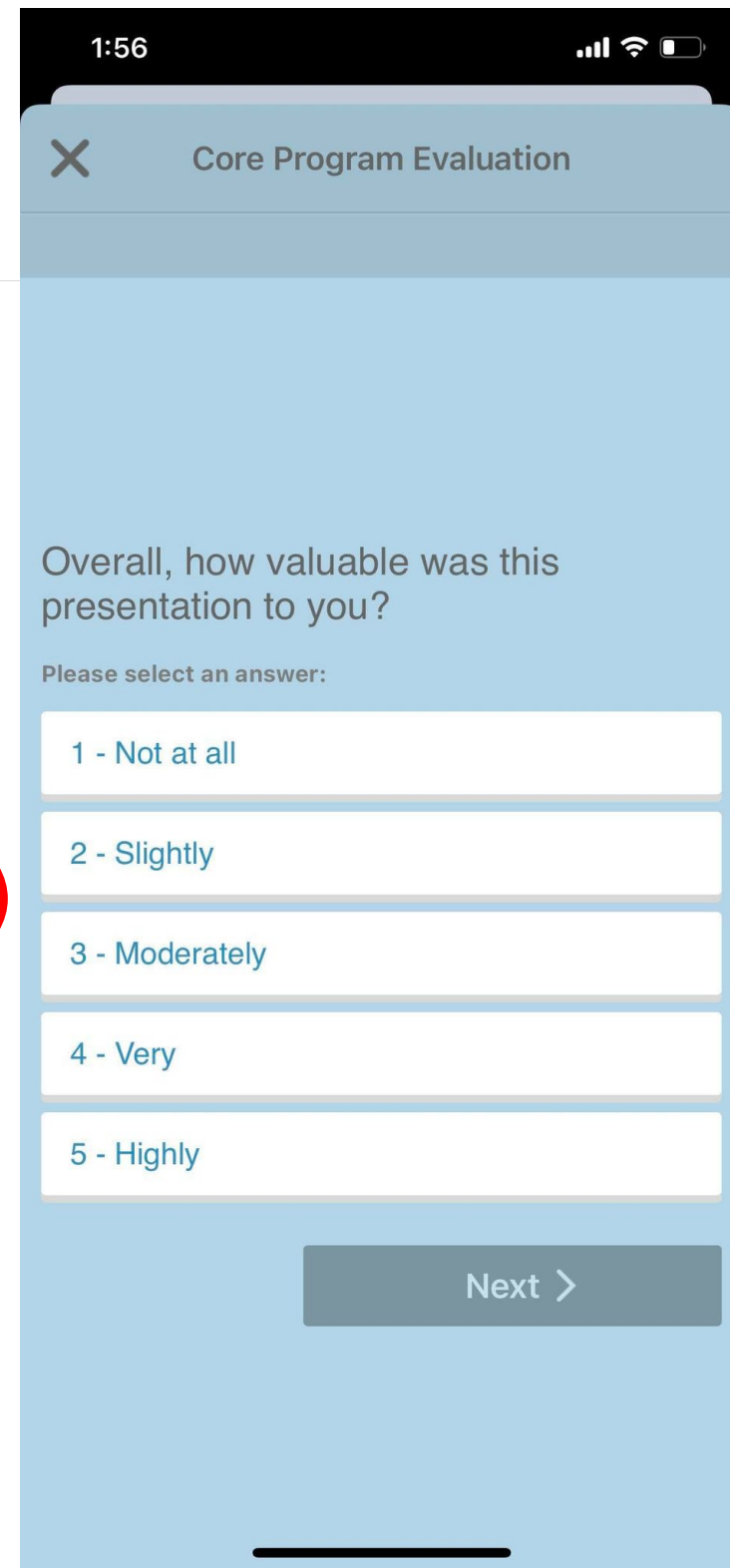
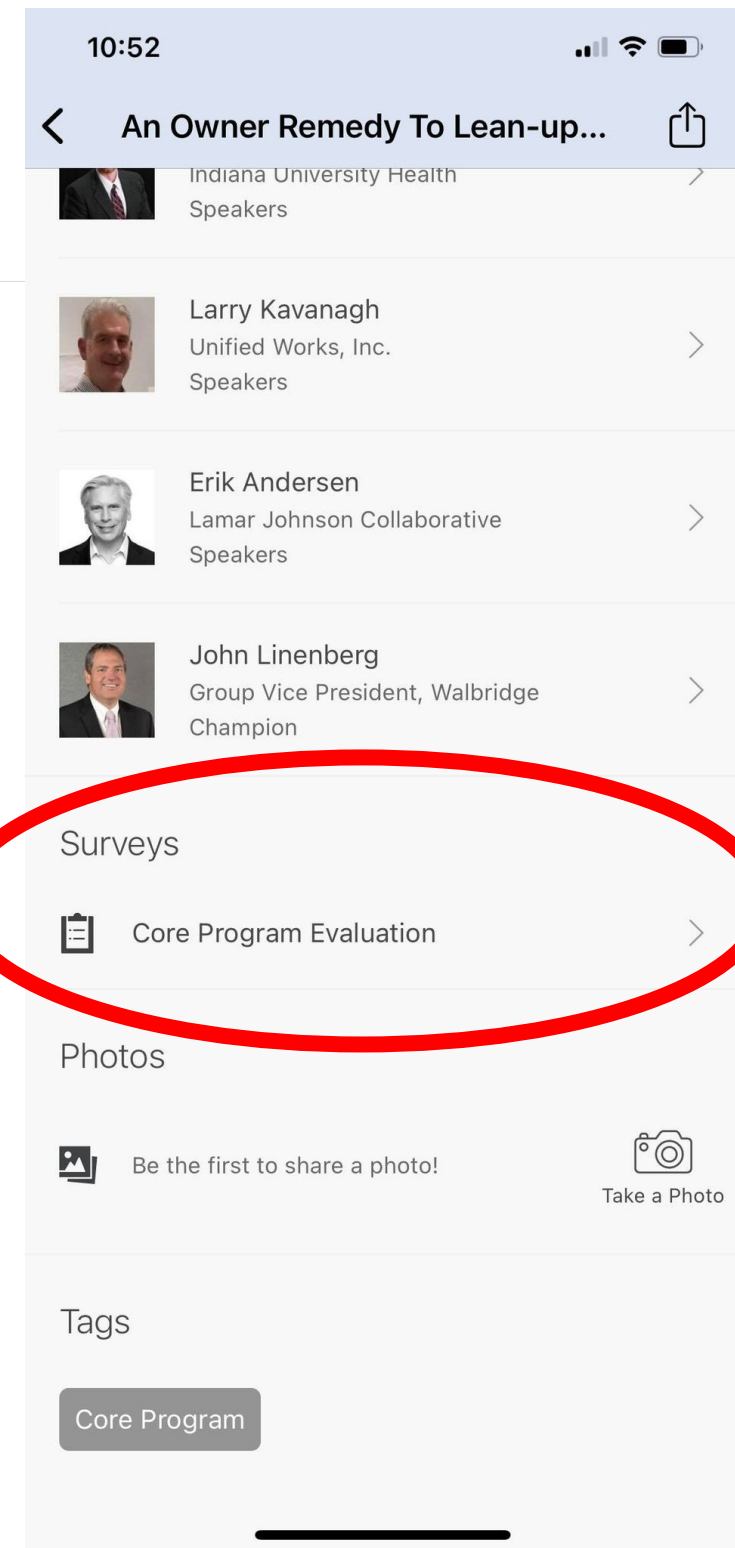

It's not too late to add a Gemba tour to your registration!

- Friday morning, October 22nd:
 - **Arizona State University's Interdisciplinary Science and Technology Building 7**
 - 281,000-square-foot, high-performance research facility.
 - During the tour, attendees will learn more about how the team has leveraged key lean practices and tools.
 - **DIRTT's Lean Culture Transformation**
 - DIRTT will demonstrate various Lean production processes:
 - Engagement wall.
 - SQDIP board.
 - One piece flow line.
 - Tool clip sample board.
 - 5S sinner sheet metal arena.
 - **Northeast Ambulatory Care Center**
 - 200,000SF Community Care Center.
 - This a Native American community site. Construction was managed with Lean tools and processes including The Last Planner System®, Kaizen, and more.

Go to the registration desk to add one of these tours to your registration!



Congress Theme and Tracks

Learn by Doing From Those Who Do

Leveling Imbalances in Lean Learnings:

- How do you drive Lean into every corner of your project team/organization?
- How do you meet team members “where they are” on their Lean journey?

Lean Learnings from Prefabrication:

- How should the different project partners, including owners, designers, general contractors, trades and inspection authorities, come together to maximize the impact of prefabrication on a project?

Lean Learnings from the Field:

- What unique practices have been adopted by your field personnel to optimize installation, decrease waste and promote safe practices?

Lean Learnings from the Design Community:

- How can design drive Lean delivery during the design process and bring in relevant parties from conception to closeout.

Extended Congress Planning Team – Learning Day Team

Co-Chairs: Jose Garcia-Aranda, Alberici Constructors and Stephanie Roldan, Rosendin Electric

- Bo Guydosh, JE Dunn
- Cindy Menches, IMPACT
- Annemarie Thurnquist, Jacobs
- Michelle Whiteside, Brasfield & Gorrie



Extended Congress Planning Team – Core Program Champions

Co-Chairs: Michael Villar, Nevell Group, Inc. and Chris Vine, Hensel Phelps

- Afshan Barshan, Skender Construction
- Matt Biehl, Kinsley Construction
- Matt Bleakley, Whiting-Turner
- Matthew Boersma, The Boldt Company
- Angela Bowman, The Boldt Company
- Travis Branham, KHS&S Contractors
- Rachel Butcher, Whiting-Turner
- Chris Dierks, DPR Construction
- Felipe Engineer Manriquez, McCarthy Building Companies
- Kate Edwards, Whiting-Turner
- Jose Garcia-Aranda, Alberici Constructors
- Melanie Gilbertson, Flintco, LLC
- Sean Graystone, Project Leadership And Delivery
- Dave Hagan, Devenney Group
- Chad Halmrast, TD Industries
- Jacob Hausmann, The Boldt Company
- Spencer Hohn, Brasfield & Gorrie
- Lydia Knowles, Turner Construction
- Nick Krey, US CAD
- Matt Lafflam, Stantec
- John Linenberg, Walbridge
- Ken McBroom, McCarthy Building Companies
- Colin Milberg, ASKM and Associates
- Ben Mlinar, Rosendin Electric
- Henry Nutt, Southland Industries
- Heather Ormonde, Flintco, LLC
- Victor Ortiz, Ortiz Consulting Services
- Randy Phillips, Skanska
- Tom Richert, RisingTerrain LLC
- David Rossi, DPR Construction
- Graham Ryan, The Boldt Company
- Jason Schulist, The Boldt Company
- Daniel Shirkey, Balfour Beatty
- Timothy Singleton, Wellesley College
- Jake Snyder, Hoar Construction
- Greg Stedman, KHS&S Contractors
- Matt Thomas, Whiting-Turner
- Blake Tormey, KHS&S Contractors
- Peter Ukstins, AXA XL Insurance
- Bryan Wahl, Bostwick Design Partnership
- Tom Weathers, Landis Construction
- Steve Wilson, HMC Architects
- Brian Wunningham, Field Driven Lean
- Arthur Winslow, Gilbane
- John Zachara, Integrated Facilities Solutions



Extended Congress Planning Team – Abstract Review Team

Chair: Kevin Labrecque, Sevan Multi-Site Solutions

- Matt Bleakley, Whiting-Turner
- Jason Bredbury, VFR Advisors
- Darlene Cadman, SPS+ Architects
- Jeff Creighton, Barton Malow
- Julie Davis, DPR Construction
- Chris Dierks, DPR Construction
- Felipe Engineer-Manriquez, McCarthy Building Companies.
- Melanie Gilbertson, Flintco, LLC
- Lydia Knowles, Turner Construction
- Jennifer Lacy, Robins Morton
- John Linenberg, Walbridge
- Hal Macomber
- Daniel Shirkey, Balfour Beatty
- Jake Snyder, Hoar Construction
- Andrea Sponsel, HKS
- Greg Stedman, KHS&S Contractors
- Michael Villar, Nevell Group
- Chris Vine, Hensel Phelps
- Tom Weathers, Landis Construction
- Michael Williams, Stantec



How does LCI pick abstracts for the core program?...

...Or how do I get my abstract selected?







How does the abstract relate to the theme, *Learn by Doing from Those Who Do*? Does it not only describe the Lean tool/technique, but does it include some element of reflection on Lean implementation and/or forward-looking elements about how this subject connects to the future of Lean practice?

- Does the abstract clearly define the problem or challenge, clearly identify Lean principles and/or tools utilized to address the challenge and leave the audience with actionable information? Is it presented in a logical manner with clear application of Lean principles? Does it reflect a thoughtful, logical approach to the presentation?

- We want to encourage people to apply Lean in situations and with applications that demonstrate the versatility of Lean. This may be using it with a group that has never done it before or it may be a unique kind of project or challenge.

- Owner Presence**
- This area should include not only that an owner is a part of the presentation but whether it appears that they will have a significant role. A presentation that claims an owner's endorsement of the process but does not have an owner involved would be questionable.

- Grading: Grade 0 to 5 (5 being an owner on board with significant involvement (submitor, one of the speakers)), 3 is unclear, can't tell either way, 1 no evidence of Owner involvement)

Special Contributor Award

Lean Construction Institute recognizes
Kevin Labrecque
Senior Vice President, Performance Excellence
Sevan Multi-Site Solutions

for his ongoing support of LCI Congress in:
Abstract Review and Content Management
Transitioning of Standard Work, and
Establishment of mid-cycle Reflection Sessions

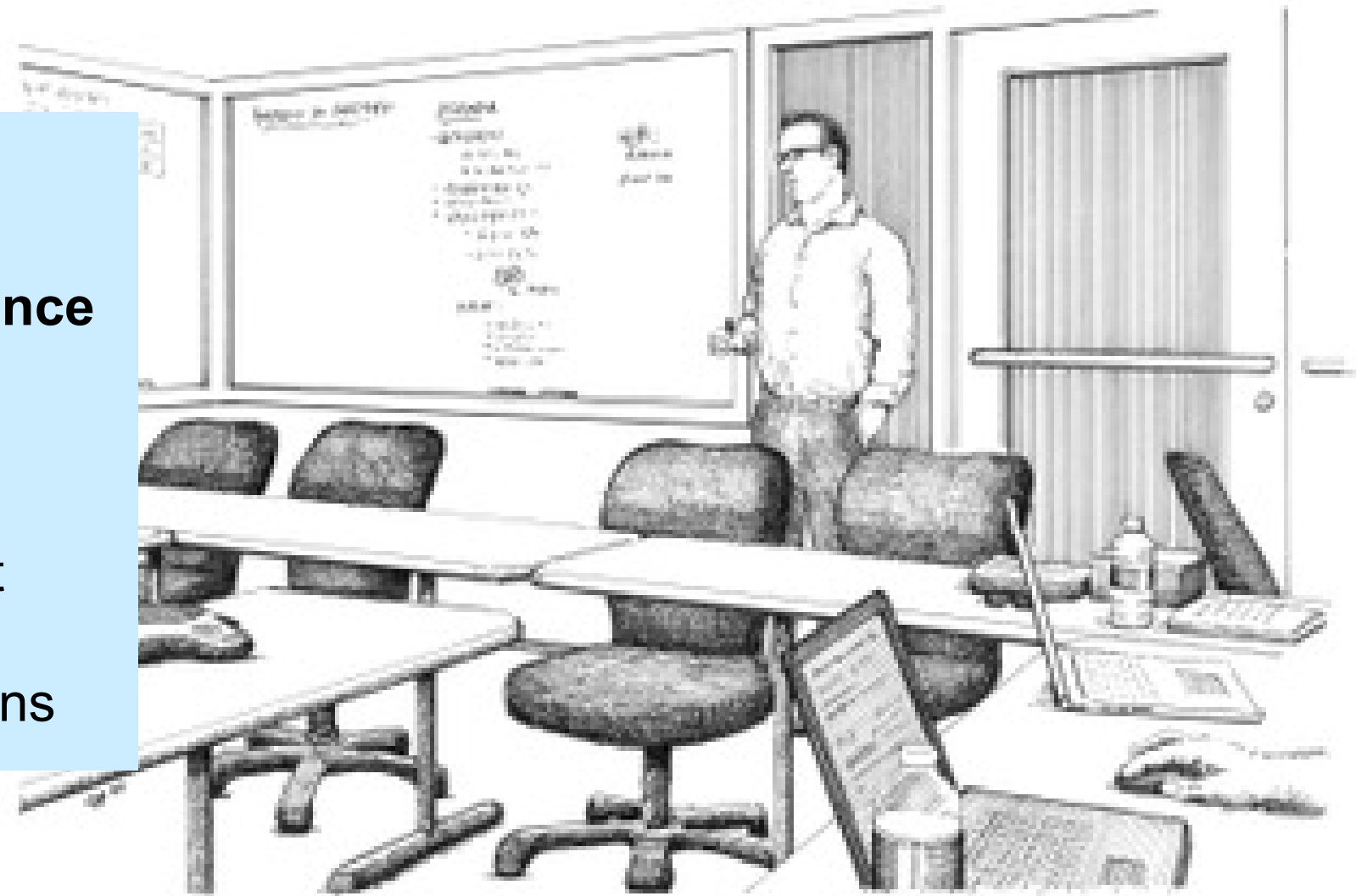

Get on social media!

Use the event hashtag #LClCongress21



**@Lean
Construction
Institute (US)**



**@Lean
Construct**



**@Lean
Construction
Institute**



**@Lean
Construct_us**

Visit our Exhibit Booths!

- Stop by and visit with our exhibitors during breaks and lunch. Refreshments will be available!



Exhibitors:





23RD LCI CONGRESS
OCTOBER 19-22

Thank you!

Enjoy the rest of the 23rd Annual
LCI Congress!