

22<sup>ND</sup> ANNUAL



22<sup>ND</sup> LCI CONGRESS  
OCTOBER 19-23

# Not just for big jobs: How prefabrication can save time and money on small projects

Kevin Mathews, Mike Alder, Brandon Owens; Pepper Construction

THE ABC'S OF LEAN: TRANSFORMATION THROUGH ACTIONS, BEST PRACTICES AND COACHING

Wednesday, October 21, 2020

# Today's Speakers



**Kevin Mathews**

Senior Project Manager



**Mike Alder**

Director of Virtual  
Construction



**Brandon Owens**

Superintendent



# The Industry Mindset





# Common Use





# The Challenge





# MRI Lab Renovation

- One room renovation
- Complete demo
- New layout & MRI equipment
- MEP rough-in, wood studs, framing, ceilings, shielding and finishes



# Typical Reno

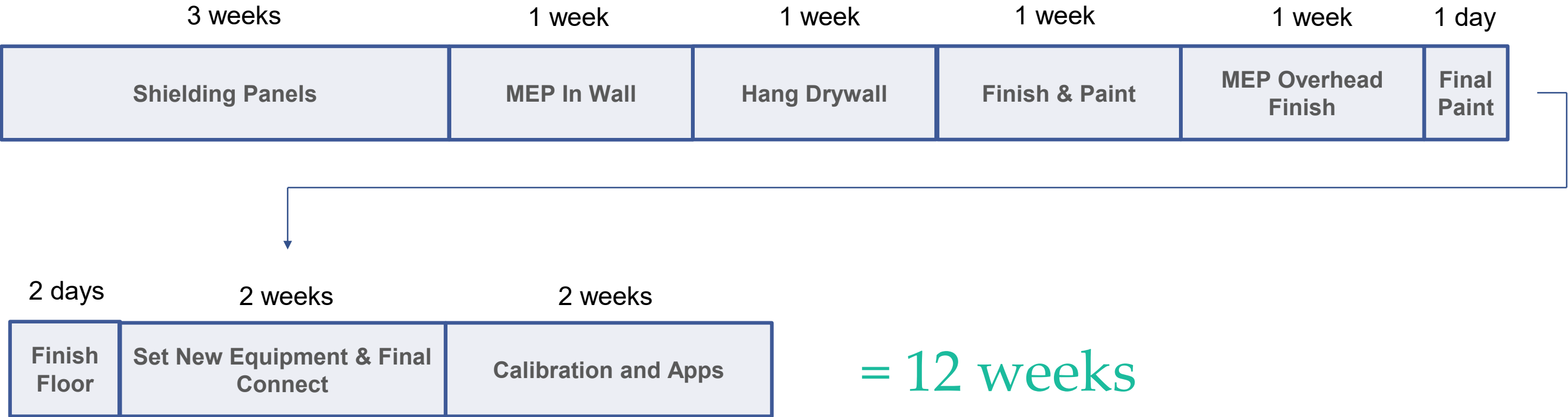

# Owner considerations

- Understanding client's values
- Equipment storage
- Remain active





# Team considerations

- Size limitations
- Transportation
- Coordination

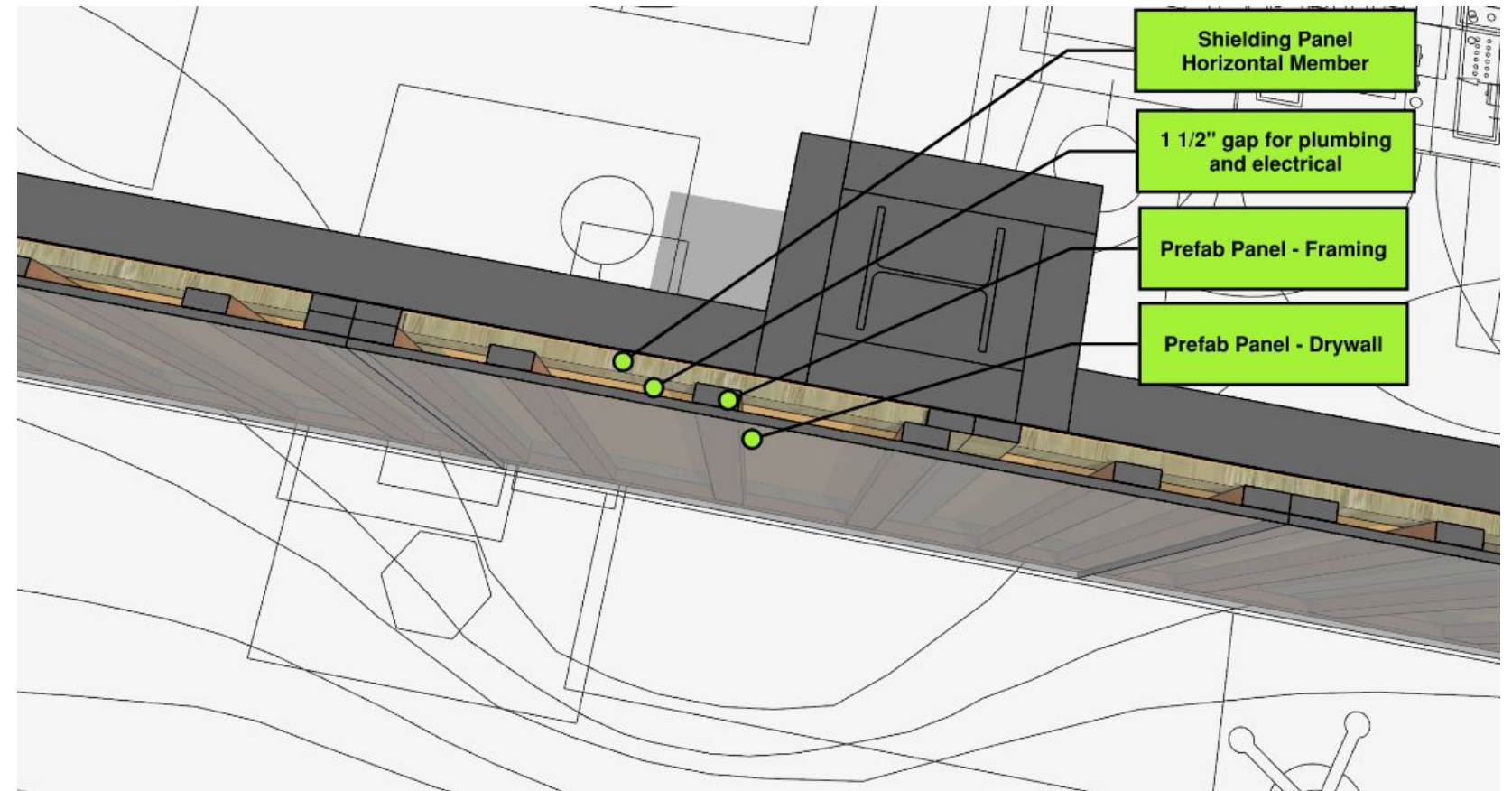

# Coordinating through Technology

## 1. Scan existing conditions





# Coordinating through Technology

## 2. Develop 3D Model of Prefab Panels

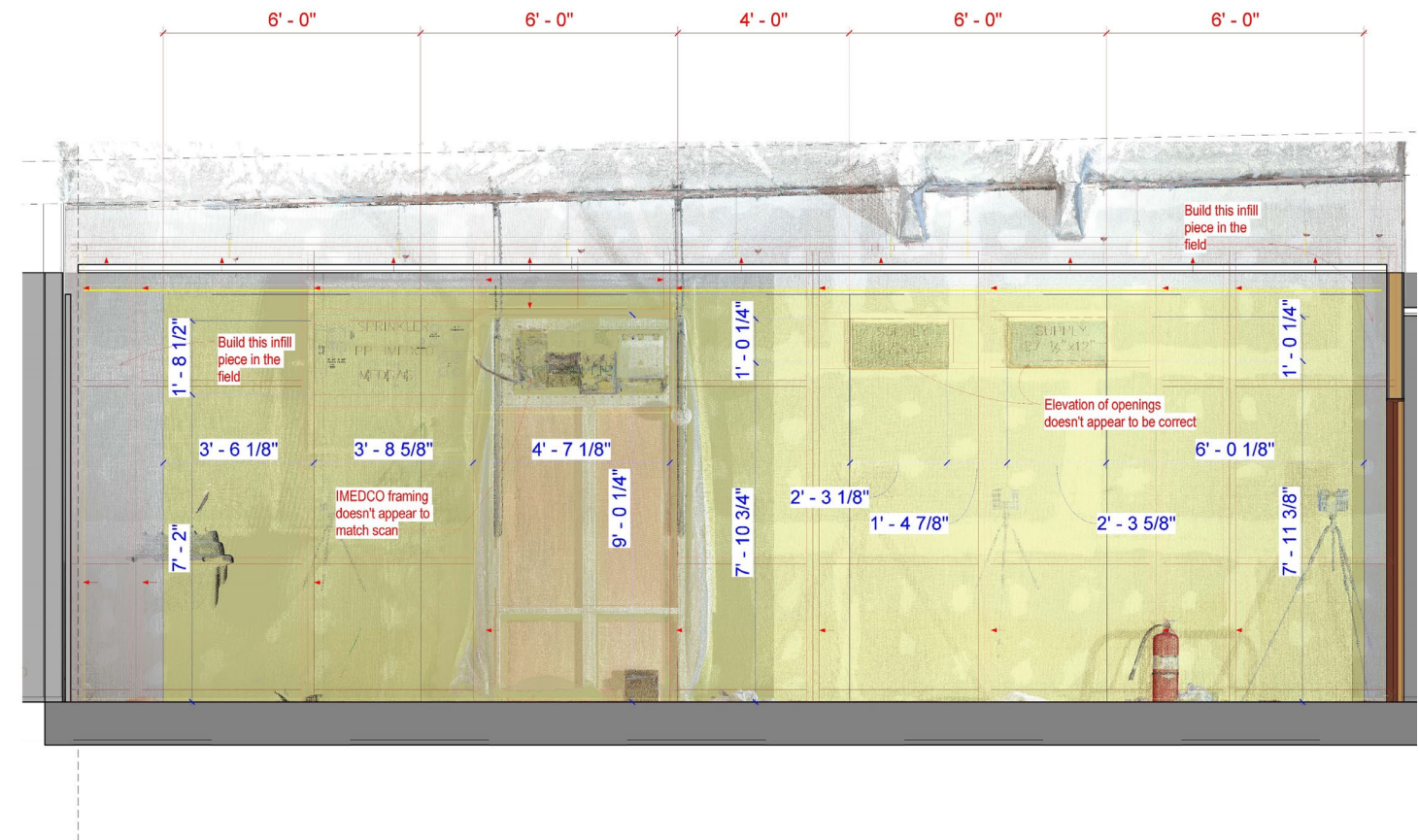



# Coordinating through Technology

## 3. Coordinate with MRI shielding shop drawings

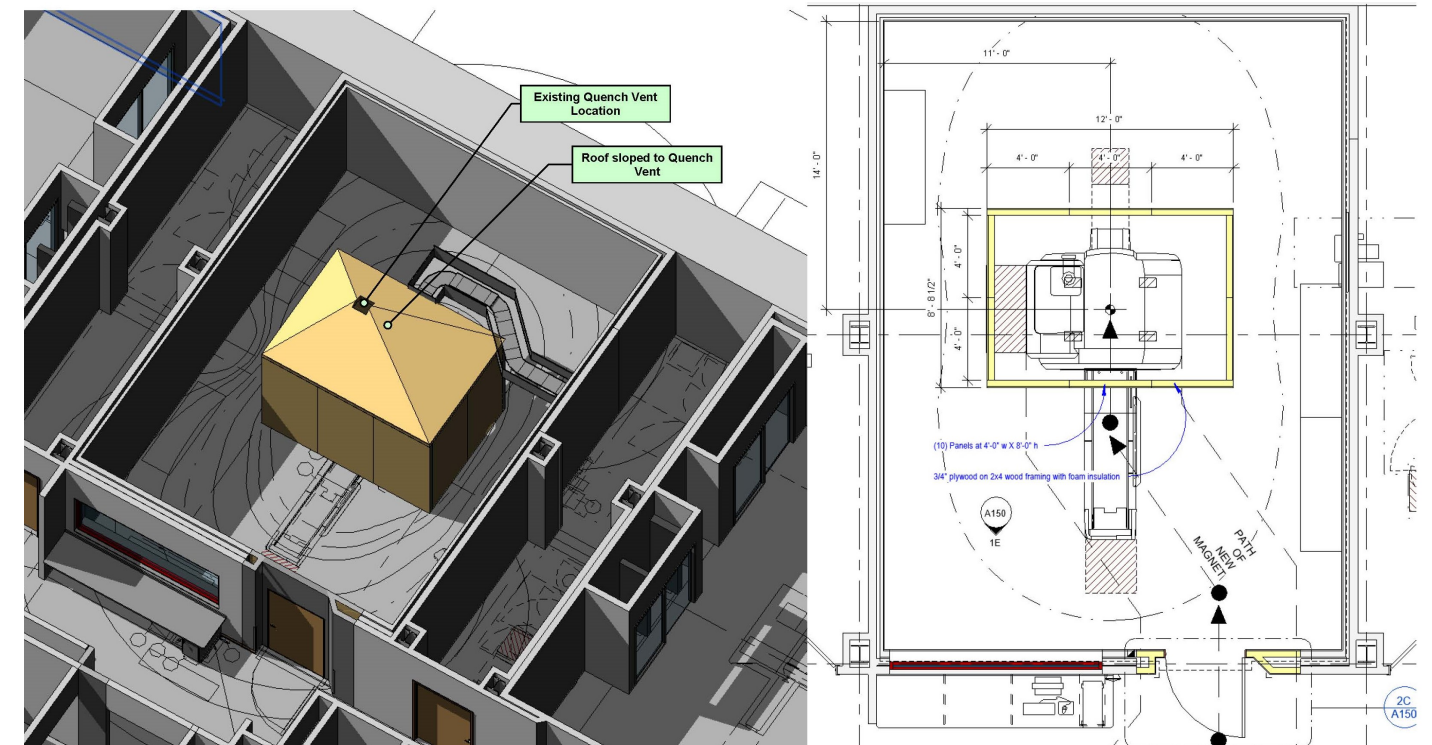

# Coordinating through Technology

## 4. Generate Prefab Panel Shop Drawings





# Collaboration

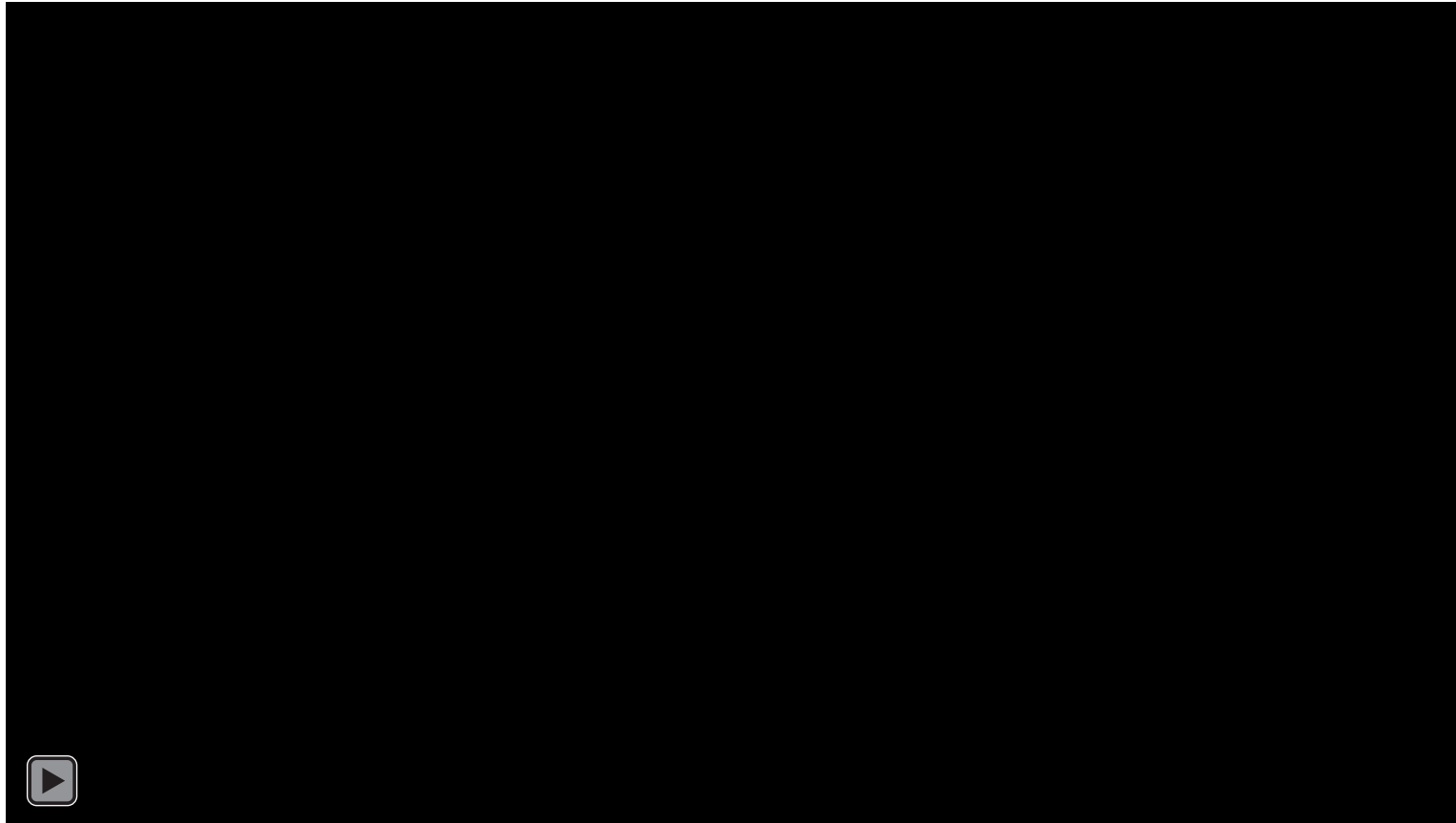



# Seeing Results



# Do

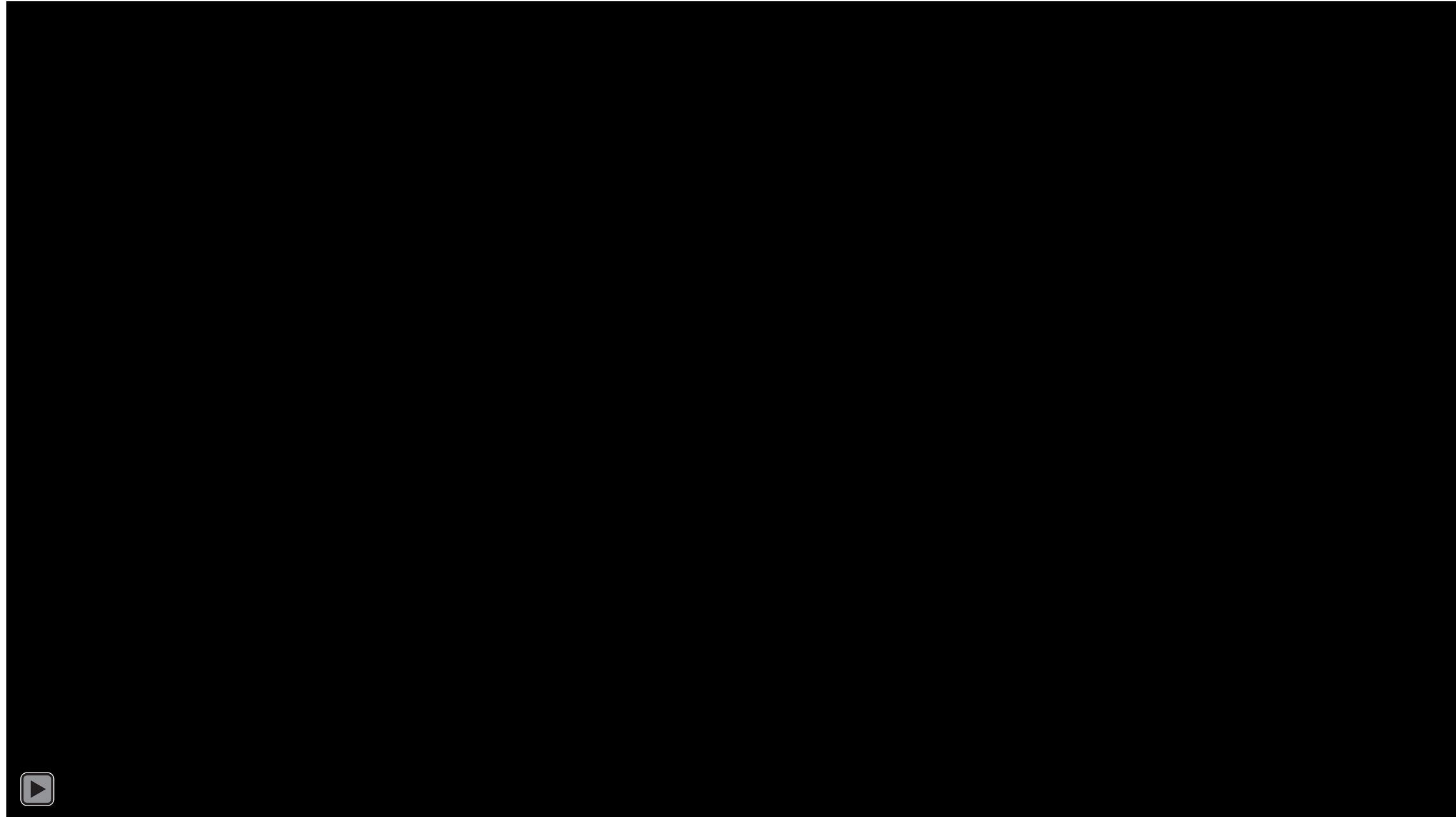

# Typical Reno vs. Prefab Schedule

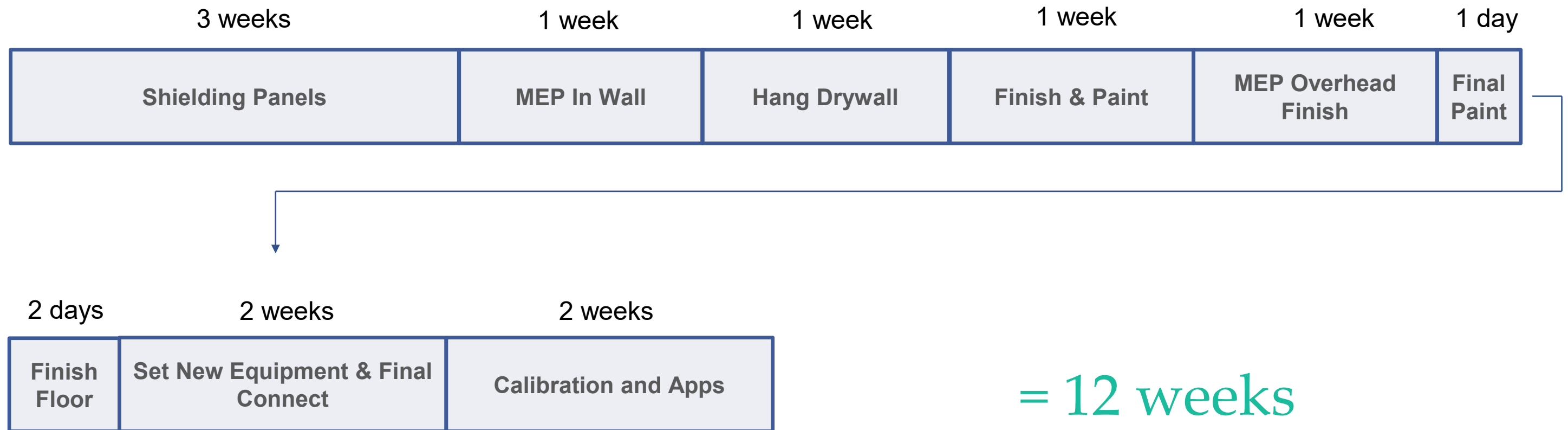



# Typical Reno vs. Prefab Schedule

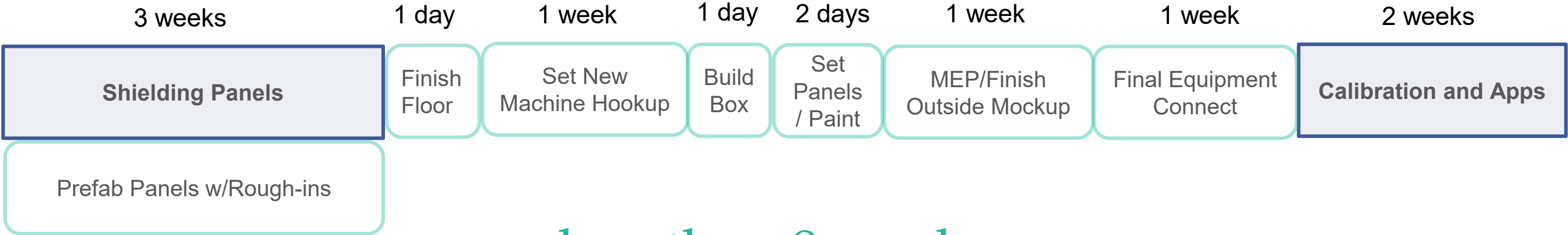
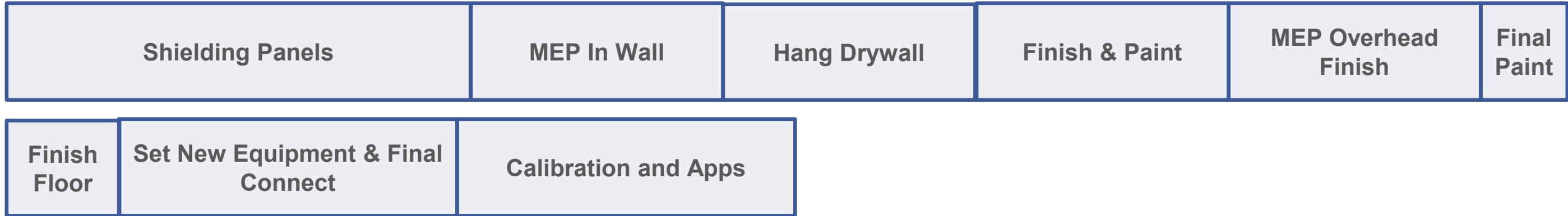

= less than 9 weeks



# What we've learned



# Key Takeaways

- Infection control
- Schedule
- Waste Management
- Communication / Buy-in
- Quality
- Client value

Even without significant construction savings, **the client's lost revenue was reduced by 30%**





# What to ask yourself

- What are the scheduling challenges?
- Does your client have such limited resources that construction would disrupt services?
- Is there an issue with downtime, equipment and/or revenue?
- Is it a controlled space where the number of people and materials need to be limited?
- How could the project affect the patient/end-user experience?



# Contact Us

**Kevin Mathews**

Pepper Construction

kmathews@pepperconstruction.com

**Mike Alder**

Pepper Construction

malder@pepperconstruction.com

**Brandon Owens**

Pepper Construction

bowens@pepperconstruction.com





**22<sup>ND</sup> LCI CONGRESS**  
**OCTOBER 19-23**



**In the spirit of continuous improvement, we would like to remind you to complete this session's survey in the Congress app! We look forward to receiving your feedback. Highest rated presenters will be recognized.**



**22<sup>ND</sup> LCI CONGRESS**  
**OCTOBER 19-23**

**Thank you for attending this presentation. Enjoy the rest of the 22<sup>nd</sup> Annual LCI Congress!**